

**HPA series** – For installation into poured concrete walls, foundations, or masonry. The HPA is the heavy-duty version of the PA anchor.

**PA series** – For installation into poured concrete or concrete block walls and foundations.

**PAI series** – For wood I-Joist applications. An expanded 3" on-center nail spacing reduces splitting along I-Joist flange.

**Materials:** HPA – 10 gauge; PA / PAI – 12 gauge

**Finish:** G90 galvanizing

**Options:** See chart for Corrosion Finish Options

**Codes:** IBC 1620.2.1

**Installation:**

- Use all specified fasteners. See Product Notes, page 18.
- Minimum concrete strength is 2,500 psi.
- The allowable loads for bolts are based on parallel to grain loading with a 3" minimum member thickness, except the HPA which requires a 3-1/2" thick wood member. Reduce load per code requirements when minimum member thickness is not achieved.
- Minimum concrete end/edge distance is 4" for PA / PAI series, and 6" for HPA series.
- Minimum CMU end/edge distance is 20".
- Designer may specify alternate fastening schedules. Refer to Nail Specification Table on page 23 for nail shear values. Load values shall not exceed published allowable loads.
- No anchor bolts are needed for achieving efficient stress transfer from framing to concrete walls or foundations.



Typical PA holdown installation

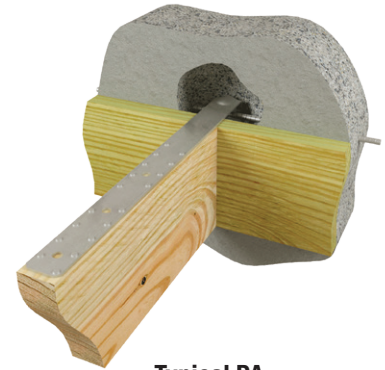

Typical PA purlin installation

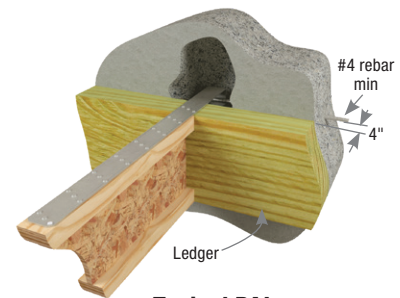

Typical PAI I-Joist purlin face installation

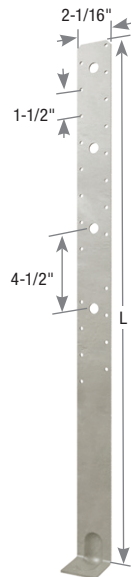

PA / HPA



PAI

Holdowns

Copyright © 2020 MiTek Industries, Inc. All Rights Reserved

Continued on next page

MiTek USP Stock No.	Ref. No.	L (in)	Minimum Embedment		Nailer Size	Fastener Schedule <sup>5</sup>				DF/SP Allowable Tension Loads (Lbs.) <sup>1,3</sup>				Corrosion Finish	Code Ref.
			Concrete	Masonry		Min Qty <sup>6</sup>				Concrete		Masonry			
						Nails <sup>4,7</sup>		Bolts		Nails	Bolts <sup>2</sup>	Nails	Bolts <sup>2</sup>		
			Qty	Nail		Qty	Dia.	160%	160%	160%	160%				
PA18	PA18	18-1/2	4	6	Max Capacity	12	16d	2	1/2	3035	2260	3035	2260	Green	
					2x & 3x Ledger										
					4x Ledger										
PA23	PA23	23-3/4	4	6	Max Capacity	15	16d	3	1/2	3700	3265	3035	3035	Green	
					2x & 3x Ledger										
					4x Ledger										
PA28	PA28	29	4	6	Max Capacity	15	16d	4	1/2	3700	3700	3035	3035	Green	
					2x & 3x Ledger										
					4x Ledger										
PA35	PA35	35	4	6	Max Capacity	15	16d	4	1/2	3700	3700	3035	3035	Green	
					2x & 3x Ledger										
					4x Ledger										
HPA28	HPA28	29	6	8	Max Capacity	23	16d	4	1/2	5055	4280	3035	3035	Green	
					2x & 3x Ledger										
					4x Ledger										
HPA35	HPA35	35	6	8	Max Capacity	23	16d	4	1/2	5425	4280	3035	3035	Green	
					2x & 3x Ledger										
					4x Ledger										
PAI18	PAI18	18-1/2	4	6	Max Capacity	12	10d x 1-1/2	--	--	2475	--	2475	--	Green	
					2x & 3x Ledger					2475		1855			
					4x Ledger					2270		1855			
PAI23	PAI23	23-1/2	4	6	Max Capacity	18	10d x 1-1/2	--	--	3700	--	3035	--	Green	
					2x & 3x Ledger					3510					
					4x Ledger					3095					
PAI28	PAI28	28-1/2	4	6	Max Capacity	24	10d x 1-1/2	--	--	3700	--	3035	--	Green	
					2x & 3x Ledger										
					4x Ledger										
PAI35	PAI35	35-1/2	4	6	Max Capacity	26	10d x 1-1/2	--	--	3700	--	3035	--	Green	
					2x & 3x Ledger										
					4x Ledger										

Holdowns

- 1) Allowable Loads have been increased 60% for wind or seismic loads; no further increase shall be permitted.
- 2) The allowable loads for bolts are based on parallel-to-grain loading with 3" minimum member thickness, except HPA which requires a 3-1/2" thick wood member.
- 3) Allowable loads are based on the use of either nails or bolts; nail and bolt values cannot be combined.
- 4) 16d sinkers or 10d common nails may be substituted for the specified 16d common nails at 0.85 of the table loads.
- 5) For alternate nail schedule and load values consult MiTek.
- 6) Minimum quantity of fasteners to be installed. Product may have additional fastener holes not needed to meet published allowable load of product.
- 7) **NAILS:** 10d x 1-1/2 nails are 0.148" dia. x 1-1/2" long, 16d nails are 0.162" dia. x 3-1/2" long.

**Corrosion Finish** ■ Stainless Steel ■ Gold Coat ■ HDG ■ Triple Zinc